

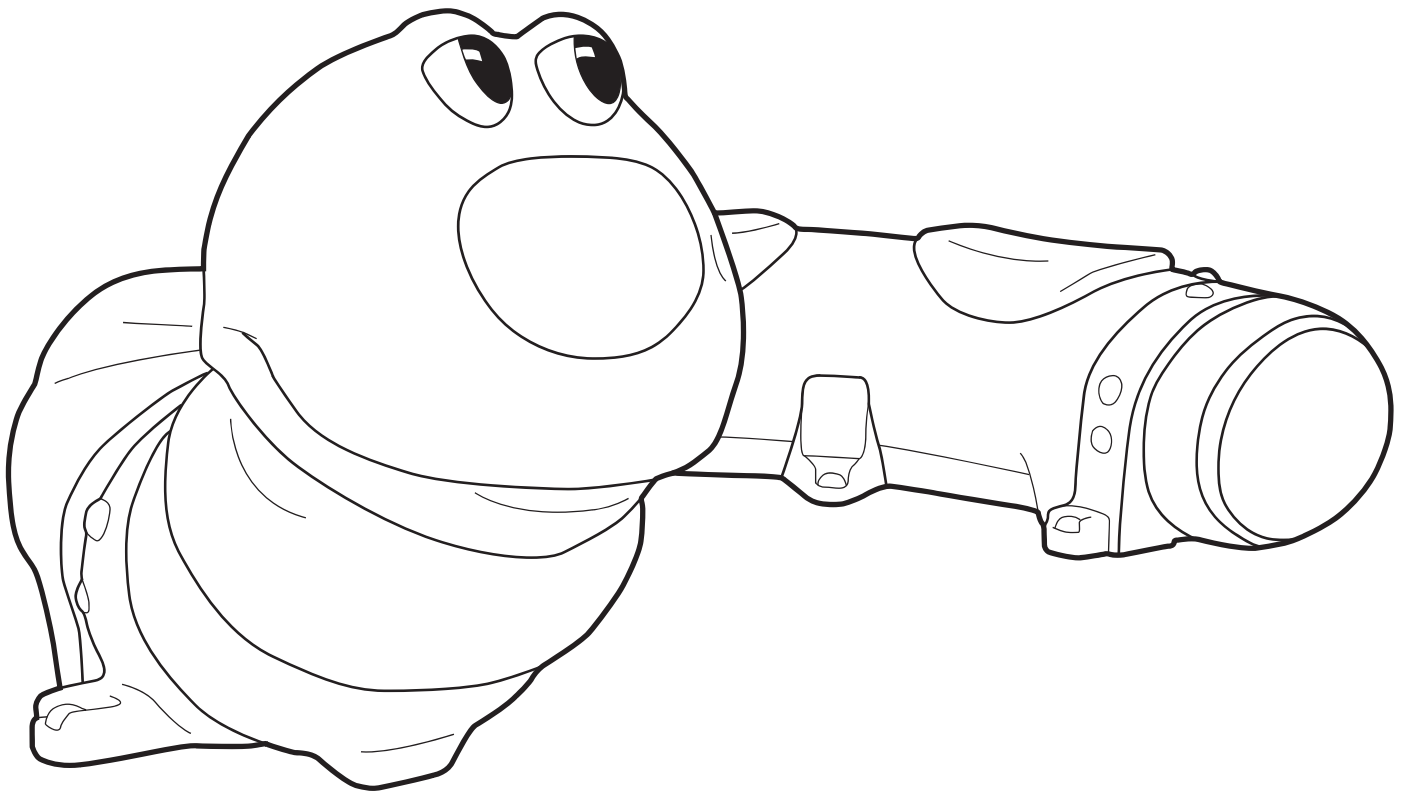

Children's Novelty Seat
INSTALLATION INSTRUCTIONS AND USER MANUAL



For Concrete Foundation Fixing Instructions Please Refer to Pages 1-3.
For Optional Sand Ballast Instructions Please Turn to Page 4.
For PVC Feet Fixing Instructions Please Refer to Pages 4-6.

IMPORTANT NOTE: PLEASE ENSURE THAT ALL RELEVANT PERSONNEL READ THE POINTS LISTED WITHIN THIS LEAFLET AND THAT A COPY IS GIVEN TO STAFF INVOLVED WITH THE INSTALLATION AND MAINTENANCE OF THIS PRODUCT.

SAFETY NOTE: PLEASE REFER TO 'THE MANUAL HANDLING OPERATIONS REGULATIONS 1992' DURING HANDLING.

CONCRETE FOUNDATION FIXING INSTRUCTIONS

Important information to consider prior to assembly and positioning of 'Munchy':

- An established concrete base area must be a minimum of 50mm deep (approx. standard concrete paving thickness). If concrete paving is the chosen base material ensure that the fixing holes to be drilled ($\varnothing 16\text{mm}$) are positioned no closer than 100mm to any edges of the slab area. This can be determined by placing the sections together on the surface without using any part fixings.
- During drilling of 16mm holes in pavement thickness concrete it is advisable to use the hammer action of the drill only part way through the drilling operation hole depth. The remaining depth to drill is best done without the hammer action applied. This will enable the fixing to set correctly when tightened.
- When drilling the fixing hole points through the mouldings into the concrete surface care should be taken to drill as central as possible to avoid damaging the plastic surrounding the hole point.
- When drilling into concrete all concrete dust formed is best cleared from the holes as much as possible as large amounts of dust that remain in the hole could prevent the fixing setting down in the correct position.

KIT CONTENTS

A- Hex Head Screw M10	x9
B- M10 Grip Washer	x27
C- M10x40 Washer	x9
D- Spacer	x9
E- M10x60mm Anchor Shield	x9
F- Cover Cap Upper	x26
G- M10x20 Washer	x26
H- Cover Cap Lower	x26
I- Socket Button Screw M10	x18
6mm Allen Key	x1

TOOLS REQUIRED

- Hammer Drill (Electric version recommended)
- 16mm Masonry Drill (to drill 120mm deep)
- Med Size Metal Hammer
- Nylon or Rubber Hammer
- 17mm Tube Spanner and Wrench
- Safety Goggles

FIXING 1

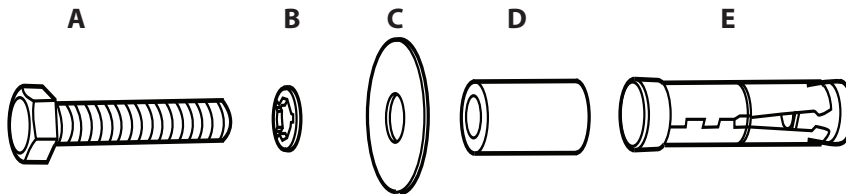

Figure 1

FIXING 2

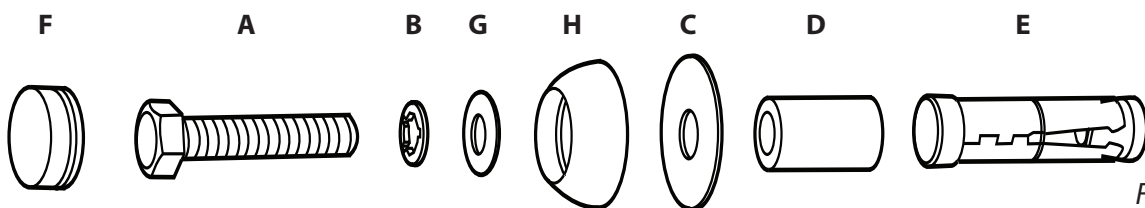

Figure 2

FIXING 3

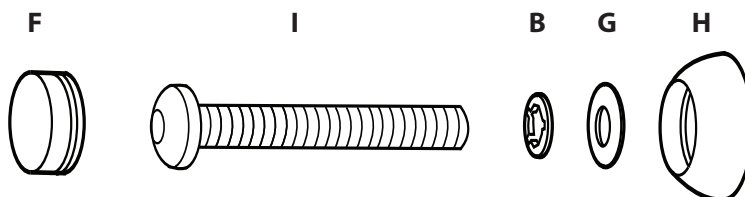

Figure 3

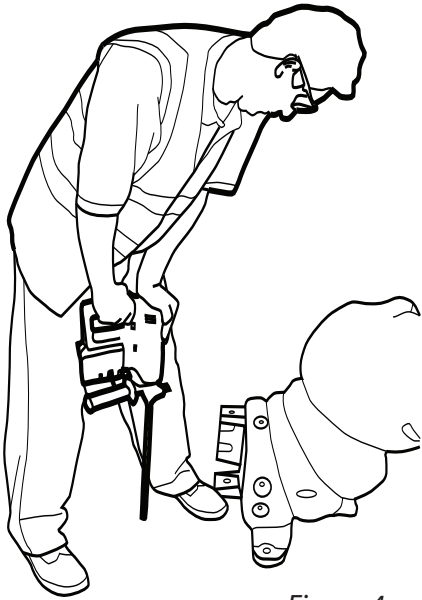

Figure 4

STEP 1 Arrange the caterpillar into the chosen configuration and location ensuring the ground is flat and all fixing points avoid existing grids etc. Carefully move away all parts except the 'Head'. Mark the ground through the middle fixing point (see figure 6) on the 'Head' and move away. This point can now be drilled to a depth of 85mm.

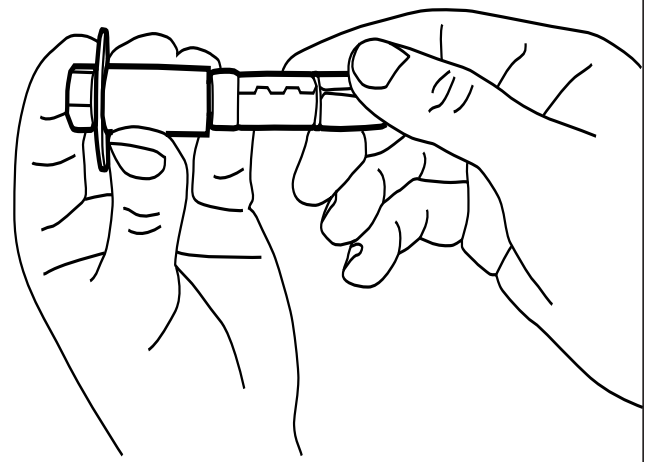

Figure 5

STEP 2 Assemble the parts for 'Fixing 1' in the order shown opposite.

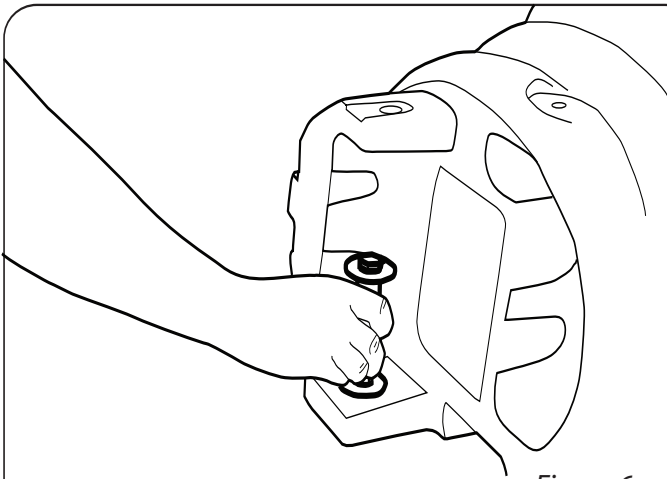

Figure 6

STEP 3 Relocate the 'Head' and insert the fixing (a hammer should be required) into the middle fixing point hole (see diagram above). Now ensure the 'Head' is in the correct position and tighten fixing using a 17mm tube spanner (maximum torque 15N.m- 12lb.ft).

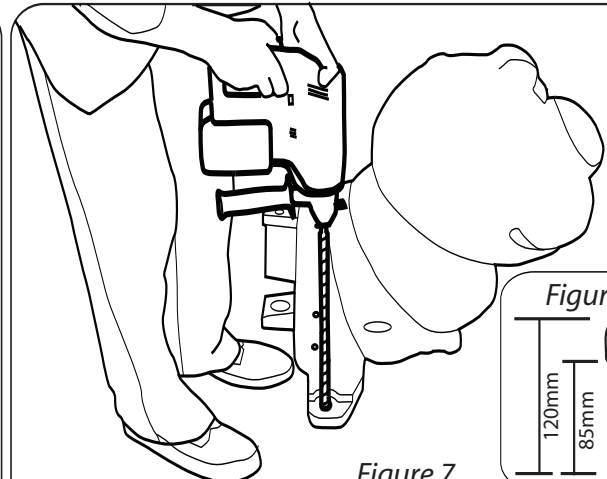

Figure 7

STEP 4 Now drill through the remaining two 'Head' fixing holes to a depth of 85mm. Figure 8 shows the required depth of the drill from ground level and including the product. This time the 'Head' does not need to be removed as the hole can be drilled through the moulding as shown above.

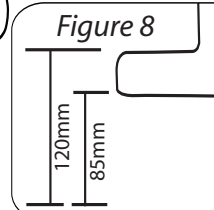

Figure 8

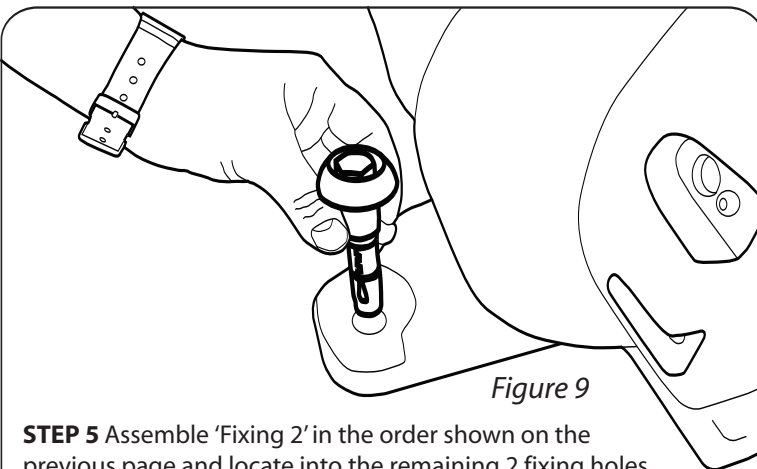

Figure 9

STEP 5 Assemble 'Fixing 2' in the order shown on the previous page and locate into the remaining 2 fixing holes. Care should be taken when tapping the fixing down not to damage the cover cap 'H'. Tighten using a 17mm Tube Spanner (max. torque 15N.m-12lb.ft) and repeat for the other remaining 'Head' fixing point. When the fixings are secure the upper cover caps 'F' can be snapped firmly into the lower cover caps 'H' (using a rubber hammer if required).

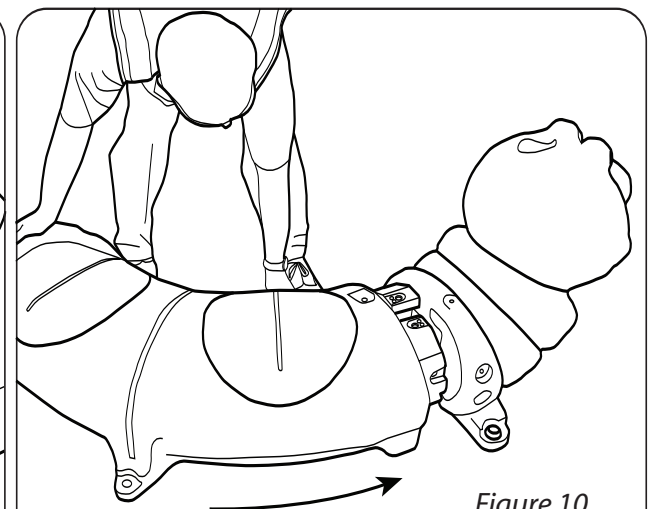

Figure 10

STEP 6 The first 'Body' module can now be moved into position as shown above. The 'Body' module will locate into the 'Head'.

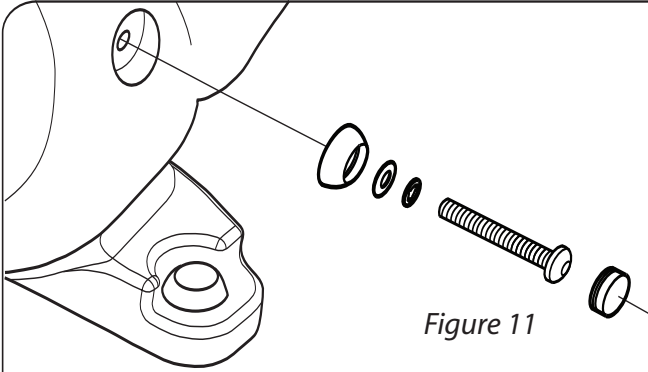

Figure 11

STEP 7 The first 'Body' module is attached to the 'Head' using 'Fixing 3'. Fixing 3 is used for all six fixing points around the 'Head' and 'Body'; loosely tighten all fixings as they are inserted and fully tighten (max. torque 5N.m-3.6lb.ft), using the 6mm Allen key provided, once all fixings are in place. Alignment at this point of both parts is essential when inserting screw 'I'. If any fixing thread will not engage correctly, lifting or shaking the 'Body' or 'Tail' part at the same time as rotating the screw will assist in the correct alignment.



STEP 8 Now that the first 'Body' part is fixed to the 'Head' the second 'Body' part (and any additional 'Body' parts) and the 'Tail' can now be slotted together and fixed in the same way as shown in STEP 7.

Figure 12

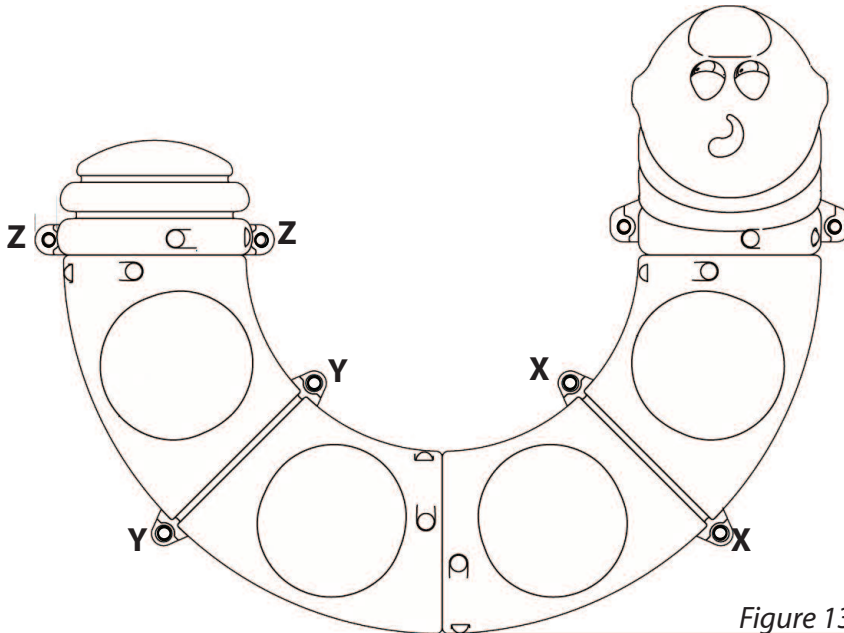

Figure 13

STEP 9 Now all parts are attached to one another, the 'Body' parts and 'Tail' need to be fixed to the ground in the same way as the 'Head'.

Please follow STEPS 4 & 5 in relation to the fixing holes on either side of the 'Body' (see diagram to the left-fixing points X), then follow STEPS 4 & 5 for fixing points Y and finally for fixing points Z located on either side of the 'Tail'.

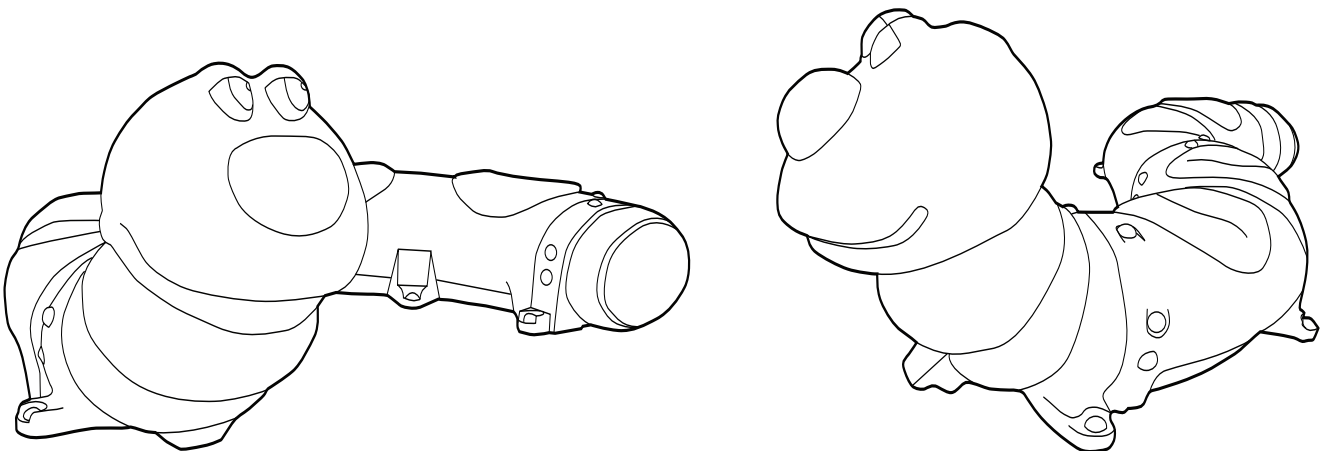
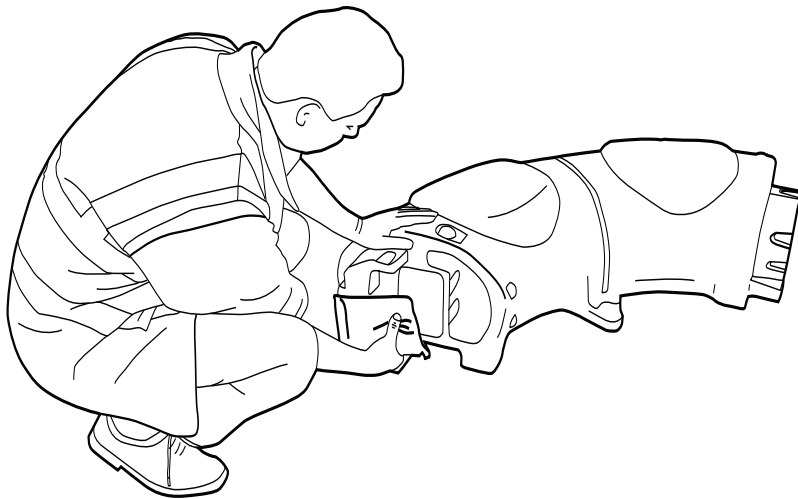

Figure 14

STEP 10 After first checking that all fixings are secure ensure that all cover caps 'F' are pushed and snapped firmly into place (a rubber hammer may assist). Munchy is now fully assembled and fixed securely to the ground. Any concrete dust on and around the product may now be cleared up, any remaining will clear naturally over time.

OPTIONAL SAND BALLAST INSTRUCTIONS - For free standing option only



The sand ballast kit includes thirty sand bags each weighing 1kg. Before assembling Munchy together the sand bags must be inserted inside as shown on the diagram. Insert 5 sand bags inside the head, 10 sand bags inside each body module (5 bags in either side) and 5 sand bags in the tail. Munchy is now ready for assembly.

PVC FEET FIXING INSTRUCTIONS

Information to consider prior to assembly of 'Munchy':

It is easier to assemble the PVC feet kit onto the individual sections before attempting to join the parts together with the fixing bolts kit or placing ballast into the individual sections. A suitable surface is required when turning over the seat to ensure the product does not become scratched. If extra ballast weight is to be used please ensure that the sand bags are in place before the parts are joined together.

KIT CONTENTS

A- PVC Buffer	x20	G- Cover Cap- Lower	x26
B- Washer	x28	H- Spacer (Large)	x8
C- Screw M6x20	x12	I- Spacer (Small)	x8
D- Cover Cap- Upper	x26	J- Screw M6x50	x8
E- Nut Nyloc M6	x8	K- Shake Proof Washer	x18
F- Nylon Shoulder Washer	x8	L- M10x20 Washer	x18
6mm Allen Key	x1	M- Socket Button Screw	x18
4mm Allen Key	x1		

TOOLS REQUIRED

- Nylon or Rubber Hammer
- M10mm Tube Spanner and Wrench

FIXING 1

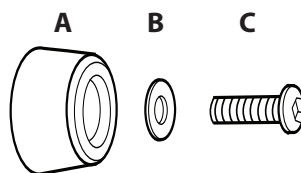

Figure 1

FIXING 2

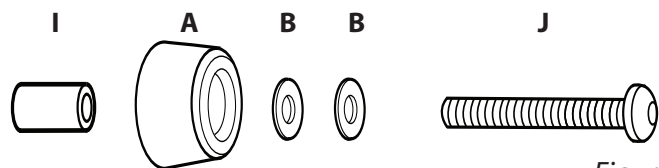
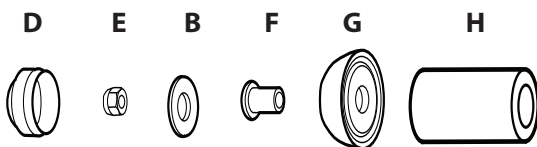

Figure 2

FIXING 3

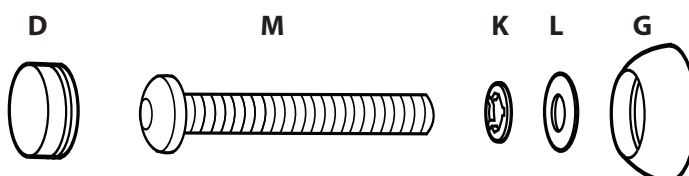

Figure 3

LOCATION OF PVC FEET (Numbers to indicate type of fixing used)

Figure 4

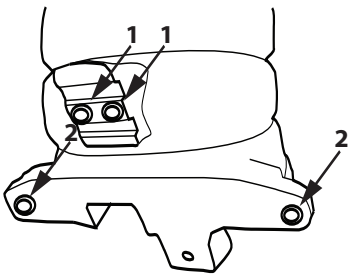

DIAGRAM SHOWING THE UNDERSIDE OF THE 'HEAD'

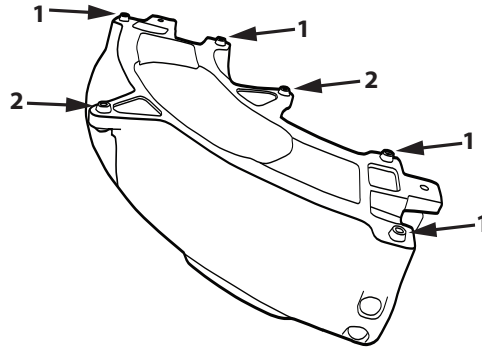

DIAGRAM SHOWING THE UNDERSIDE OF THE 'BODY'

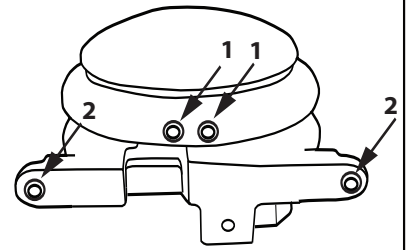

DIAGRAM SHOWING THE UNDERSIDE OF THE 'TAIL'

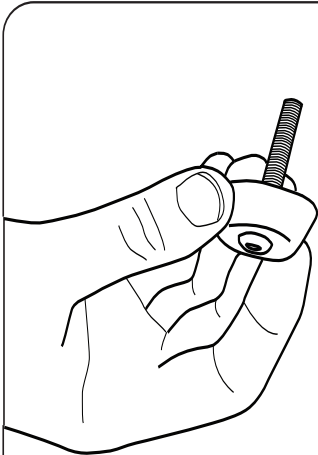

Figure 5

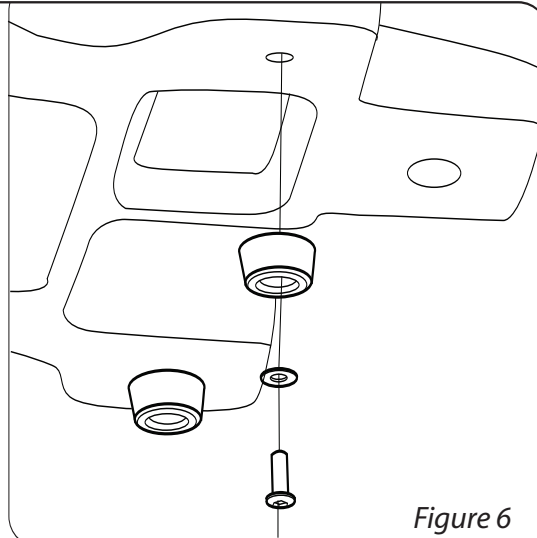

Figure 6

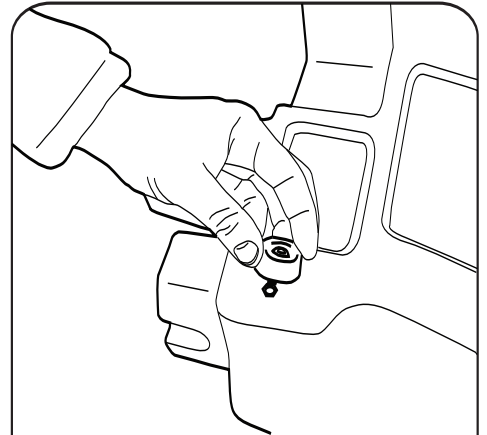

Figure 7

STEP 1 First assemble 'Fixing 1' as shown. For points where Fixing 1 is used please refer to figure 4 (Fixing 1 is used when a cover cap is not needed as the upper section of the hole cannot be seen).

STEP 2 The fixing can now be located into the hole and tightened securely using 4mm allen key provided. Repeat steps 1 & 2 for all points where Fixing 1 is used (see figure 4).

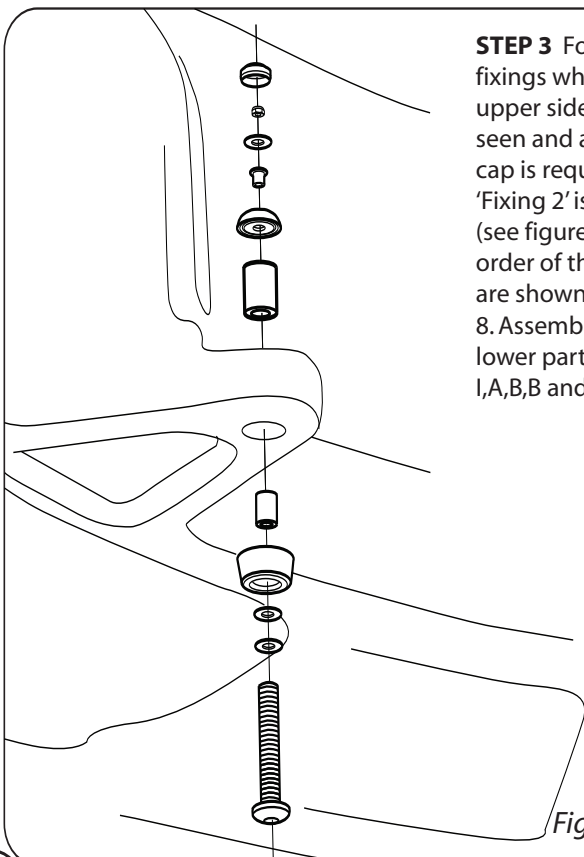

Figure 8

STEP 3 For the fixings where the upper side can be seen and a cover cap is required 'Fixing 2' is used (see figure 4). The order of these parts are shown in figure 8. Assemble the lower parts (Parts I, A, B, B and J) first.

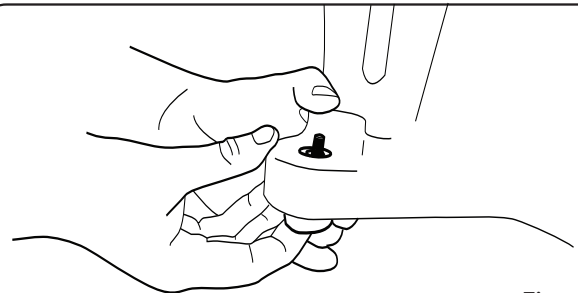

Figure 9

STEP 4 Locate these parts (Parts I, A, B, B, J) into the underside of the fixing hole.

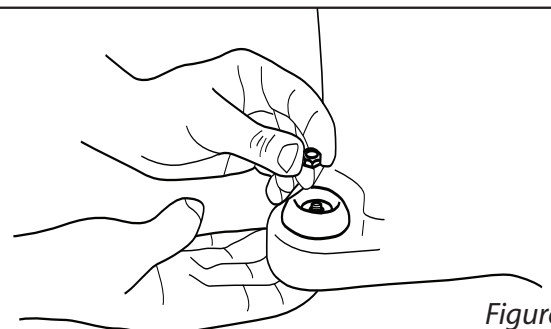

Figure 10

STEP 5 Parts E, B, F, G AND H can now be put into position onto the protruding screw.

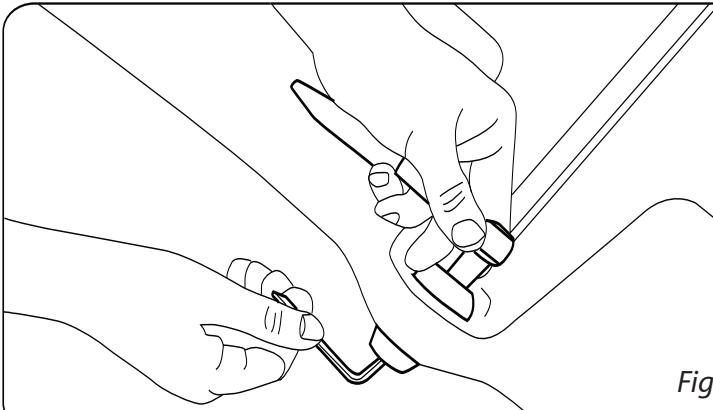
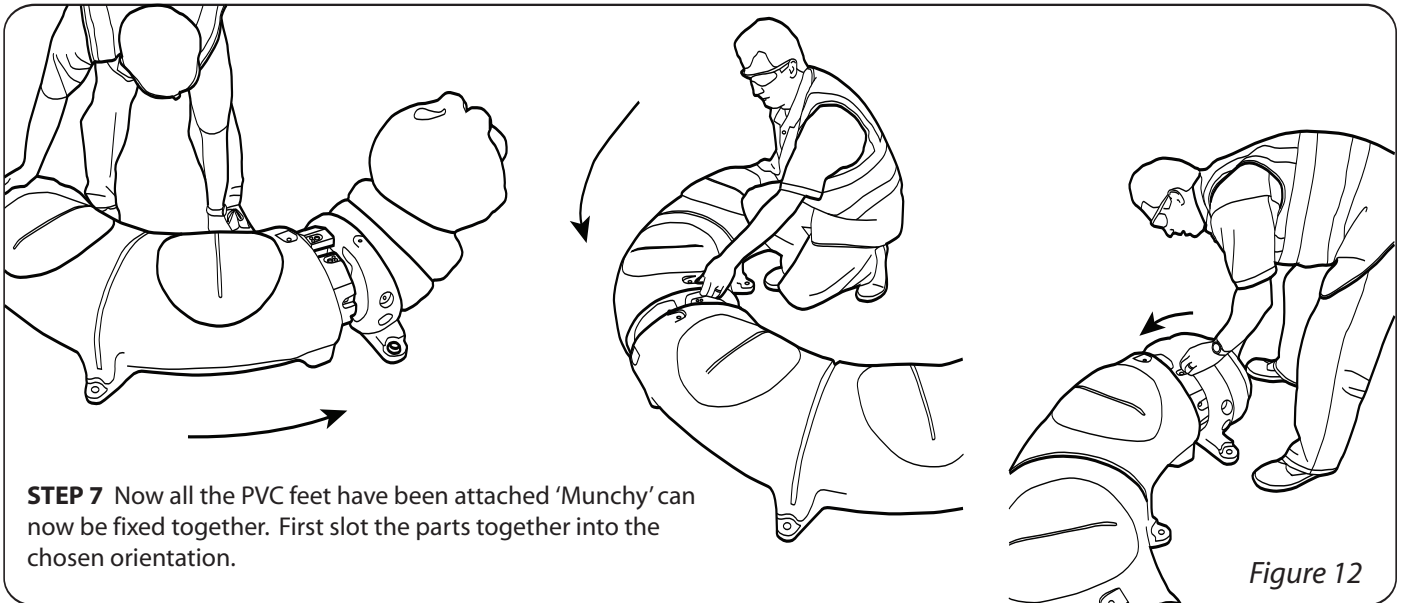

Figure 11

STEP 6 Part E (Nyloc Nut) is tightened using a M10 tube spanner. The allen key provided will hold the screw in position while the nut is tightened as shown in figure 11. The upper cover cap, Part D, can now be inserted - if resistance occurs a rubber hammer can be used to push the cover cap into place. Repeat Steps 3-6 for all points where Fixing 2 is used (see Figure 4).



STEP 7 Now all the PVC feet have been attached 'Munchy' can now be fixed together. First slot the parts together into the chosen orientation.

Figure 12

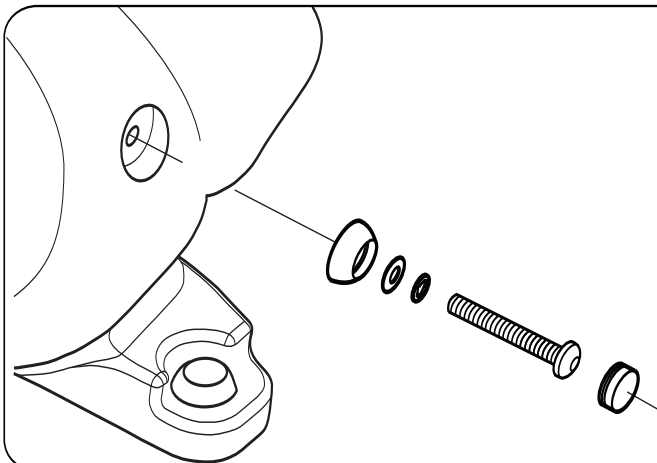

STEP 8 The parts are all attached together using 'Fixing 3'. Fixing 3 is used for all six fixing points around the head and body, loosely tighten all fixings as they are inserted and fully tighten (max. torque 5N.m-3.6lb.ft), using the 6mm Allen key provided, once all fixings are in place. Allignment at this point of both parts is essential when inserting screw 'M'. If any fixing thread will not engage correctly lifting or shaking the body or tail part at the same time as rotating the screw will assist in the correct allignment.

Figure 13

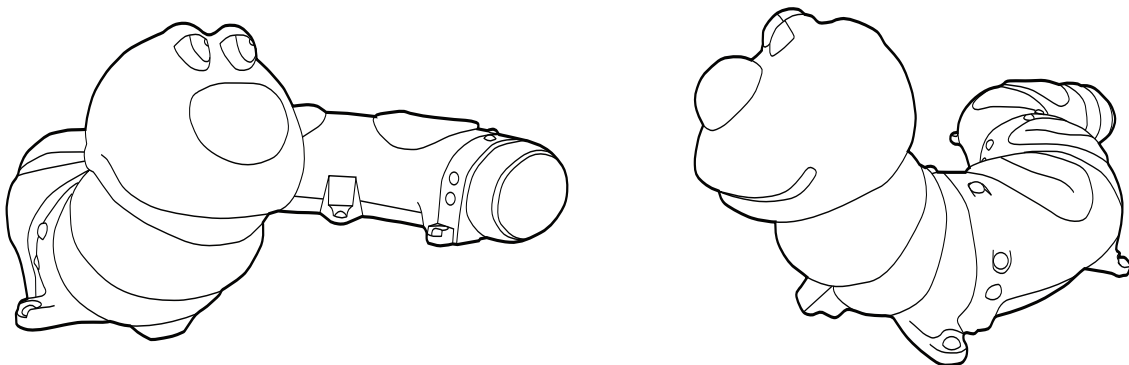

Figure 14

STEP 9 After first checking that all fixings are secure, ensure that all upper cover caps 'D' are pushed and snapped firmly into place over all lower cover caps 'H' (a rubber hammer may assist). Munchy is now fully assembled and ready for siting.

 **Glasdon** AND MUNCHY™ ARE TRADEMARKS OR REGISTERED TRADEMARKS OF GLASDON GROUP OR ITS SUBSIDIARIES IN THE U.K. AND OTHER COUNTRIES

- A planned maintenance schedule or regular inspection is recommended, replacing components as necessary.
- Replacement components are available direct from GLASDON.
- GLASDON cannot be held responsible for claims arising from incorrect installation.

**Should you require any further assistance please contact us on
tel: 01253 600410, fax: 01253 792558 or email: sales@glasdon-uk.co.uk**



In accordance with our policy of continuous development and improvement, we reserve the right to make changes in design and specification without notice.

Glasdon UK Limited products are manufactured under license worldwide and various components of the models are patented and design registered.



© Copyright Glasdon DEC2007

C000/0111